

Fuses



RT36 Knife Contact Fuse Protector

1. General

RT36 Knife contact fuse protector is a new fuse protector designed by our company and featured by small size, light weight, low consumption and high breaking capacity, etc.; and widely used for overload protection and short-circuit protection of electric device.

The series products are divided into "gG" and "aM" type; "gG" is ordinary fuse protector with full range of breaking capacity, while "aM" is fuse protector for the protection of motor with partial breaking capacity.

This product conforms to GB 13539 and IEC 60269 standards; its technical indicators have reached international advanced level.

2. Type designation

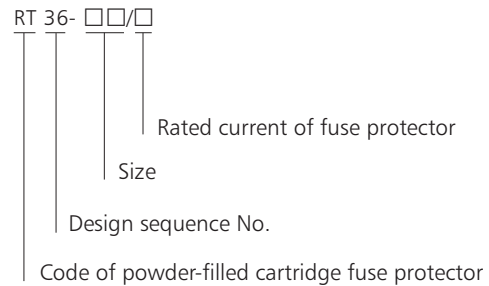

3. Technical data

Specifications	Similar models at home and abroad	Rated current (A)	Rated voltage (V)	Rated power (W)	Weight (Kg)	Breaking capacity (kA)
RT36-00C NT00C, R030A (Note: match pedestal RT36-00)		4	500	1.5	0.12	120
		6	500	1.6	0.12	120
		10	500	1.7	0.12	120
		16	500	2.0	0.12	120
		20	500	2.5	0.12	120
		25	500	3.1	0.12	120
		32	500	3.5	0.12	120
		36	500	3.8	0.12	120
		40	500	4.0	0.12	120
		50	500	5.3	0.12	120
		63	500	6.1	0.12	120
		80	500	6.9	0.12	120
		100	500	10.0	0.12	120

Table (continued)

Specifications	Similar models at home and abroad	Rated current (A)	Rated voltage (V)	Rated power (W)	Weight (Kg)	Breaking capacity (kA)
RT36-00	RT16-00(NT00)	4	AC500/AC690/DC250	1.5	0.15	120/50/100
		6	AC500/AC690/DC250	1.6	0.15	120/50/100
		10	AC500/AC690/DC250	1.7	0.15	120/50/100
		16	AC500/AC690/DC250	2.0	0.15	120/50/100
		20	AC500/AC690/DC250	2.5	0.15	120/50/100
		25	AC500/AC690/DC250	3.1	0.15	120/50/100
		32	AC500/AC690/DC250	3.5	0.15	120/50/100
		36	AC500/AC690/DC250	3.8	0.15	120/50/100
		40	AC500/AC690/DC250	4.0	0.15	120/50/100
		50	AC500/AC690/DC250	5.3	0.15	120/50/100
		63	AC500/AC690/DC250	6.1	0.15	120/50/100
		80	AC500/AC690/DC250	6.9	0.15	120/50/100
		100	AC500/AC690/DC250	10.0	0.15	120/50/100
		125	AC500/AC690/DC250	9.6	0.15	120/50/100
		160	AC500/AC690/DC250	12.0	0.15	120/50/100
		RT36-0	RT16-0(NT0)	4	500/690	1.7
6	500/690			2.0	0.2	120/50
10	500/690			1.8	0.2	120/50
20	500/690			3.0	0.2	120/50
25	500/690			3.5	0.2	120/50
32	500/690			4.05	0.2	120/50
36	500/690			4.0	0.2	120/50
40	500/690			5.1	0.2	120/50
50	500/690			7.25	0.2	120/50
63	500/690			8.1	0.2	120/50
RT36-0	RT16-0(NT0)	80	500/690	10.26	0.2	120/50
		100	500/690	12.58	0.2	120/50
		125	500/690	15.62	0.2	120/50
RT36-1	RT16-1(NT1)	160	500/690	16.0	0.2	120/50
		80	AC500/AC690/DC440	8.35	0.36	120/50/100
		100	AC500/AC690/DC440	12.05	0.36	120/50/100
		125	AC500/AC690/DC440	13.46	0.36	120/50/100
		160	AC500/AC690/DC440	16.53	0.36	120/50/100
		200	AC500/AC690/DC440	20.8	0.36	120/50/100
		224	AC500/AC690/DC440	22.69	0.36	120/50/100
250	AC500/AC690/DC440	23.0	0.36	120/50/100		
RT36-2	RT16-2(NT2)	125	AC500/AC690/DC440	21.7	0.85	120/50/100
		160	AC500/AC690/DC440	22.7	0.85	120/50/100
		200	AC500/AC690/DC440	26.8	0.85	120/50/100
		224	AC500/AC690/DC440	28.9	0.85	120/50/100
		250	AC500/AC690/DC440	28.9	0.85	120/50/100
		300	AC500/AC690/DC440	32.0	0.85	120/50/100
		315	AC500/AC690/DC440	32.45	0.85	120/50/100
		355	AC500/AC690/DC440	33.66	0.85	120/50/100
		400	AC500/AC690/DC440	34.0	0.85	120/50/100

Fuses

Table (continued)

Specifications	Similar models at home and abroad	Rated current (A)	Rated voltage (V)	Rated power (W)	Weight (Kg)	Breaking capacity (kA)
RT36-3	RT16-3(NT3)	315	AC500/AC690/DC440	34.45	0.85	120/50/100
		355	AC500/AC690/DC440	35.96	0.85	120/50/100
		400	AC500/AC690/DC440	38.09	0.85	120/50/100
		425	AC500/AC690/DC440	40.20	0.85	120/50/100
		500	AC500/AC690/DC440	45.23	0.85	120/50/100
		630	AC500/AC690/DC440	48.0	0.85	120/50/100
RT36-4	RT16-4(NT4)	800	AC500/AC690/DC440	75.08	1.95	120/50/100
		1000	AC500/AC690/DC440	90.0	1.95	120/50/100
		1250	AC500/AC690/DC440	110	1.95	120/50/100
NRT36-00	NH00	160	500/690	12	0.15	120/50

4. Overall and mounting dimensions

4.1 Fuse link size

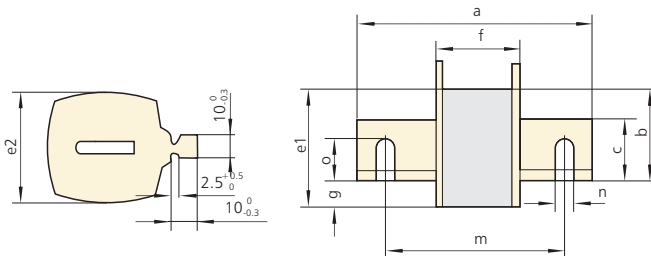

Size	RT36-00C	RT36-00	RT36-0	RT36-1	RT36-2	RT36-3	RT36-4	NRT36-00
a	78.5	78.5	125	135	150	150	200	78.5
b	35	35	35	40	48	60	83	35
c	15	15	15	21	27	33	50	15
e1	45	45	45	48	58	67	96	45
e2	20	29	29	48	58	67	88	29
f	49	49	68	68	68	68	79	49
g	10	10	11.5	12	13	14	20	11.5
m	-	-	-	-	-	-	150	-
n	-	-	-	-	-	-	16	-
o	-	-	-	-	-	-	32	-

4.2 Size of fuse protector pedestal

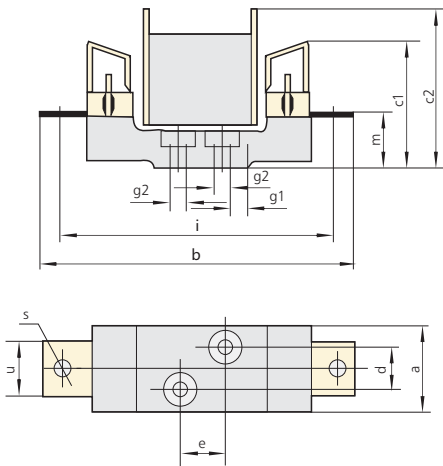

Size	RT36-00	RT36-0	RT36-1	RT36-2	RT36-3	RT36-4	NRT36-00
a	30	33	58	64	64	96	30
b	118	170	200	225	250	304	120
c1	60	73	82	98	105	145	60
c2	85	93	96	112	120	165	85
d	0	0	30	30	30	45	0
e	25	25	25	25	25	30	25
g1	8	16	15	17	17	4	8
g2	8.3	7.5	10.5	10.5	10.5	13	7.5
i	100	150	175	200	210	260	100
m	25	38	38	40	45	47.5	2.5
s	M8	M8	M10	M10	M12	M16	M8
u	25	25	25	30	40	45	25

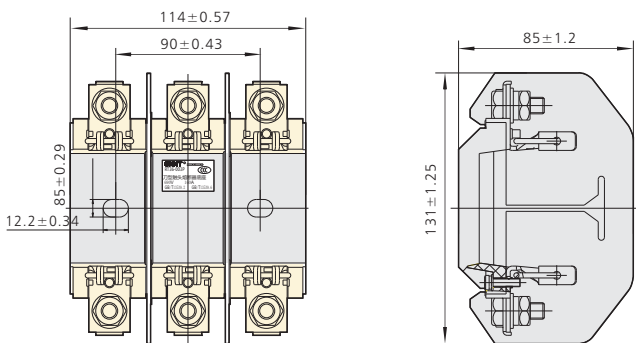

5. Ordering information

5.1 It needs to notify the following when ordering

5.1.1 Fuse link shall be marked with product model, rated current and quantity

5.1.2 Pedestal shall be marked with type, specification, pedestal mark and quantity.

5.2 Ordering example

For example: RT36-00/100A, 100 fuse links represent 100 fuse links with product model of RT36-00 and rated current of 100A.

RT36-00 100 pedestals represent 100 pedestals with product model of RT36-00.

Fuses

RT36, HDLRT0 Knife Contact Fuse Protector Protection Characteristic Curve

