



3.3 Fuse holder (chassis) and parameter of configuration of fuse-link

Fuse holder (chassis) Model	Supporting fuse protector		
	Size(mm)	Model of fuse links	Current(A)
RT29-16	8.5×31.5	RT29-16	2, 4, 6, 8, 10, 16
RT29-32	10	RT14-20, RT28-32, RT29-32	2, 4, 6, 8, 10, 16, 20
RT29-63	14	RT28-63, RT14-32, RT29-63	2, 4, 6, 8, 10, 16, 20, 25, 32
RT29-125	22	RT14-63, RT29-125	25, 32, 40, 50, 63, 80, 100, 125

**4. Schematic diagram**

Fuse chassis used with fuse-link

Matched schematic diagram of fuse protector supporter (pedestal) and fuse links with size of 10×38

Matched schematic diagram of fuse protector supporter (pedestal) and fuse links with size of 14×51

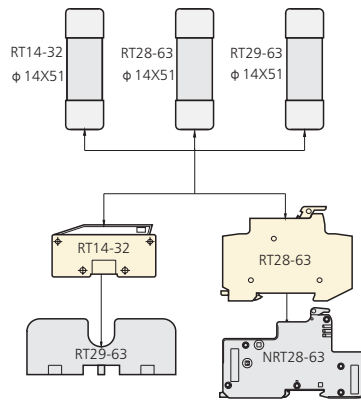
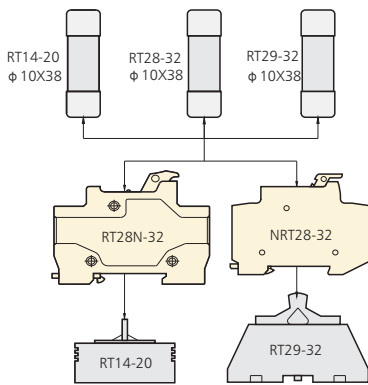

Matched schematic diagram of fuse protector supporter (pedestal) and fuse links with size of 22×58

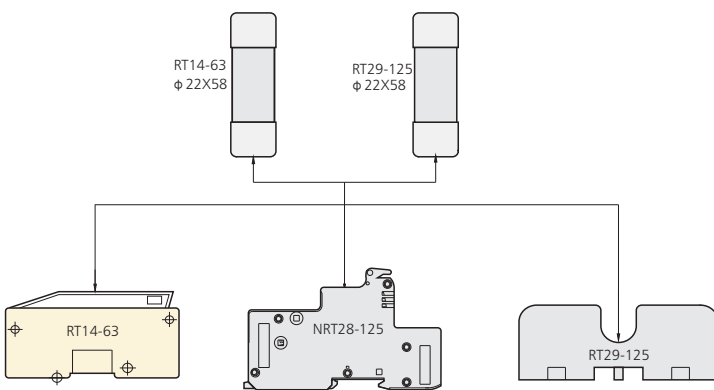

# Fuses

## 5. Overall and mounting dimensions

RT29-16 RT29-32 Chassis

RT29-16~125 Fuse-link

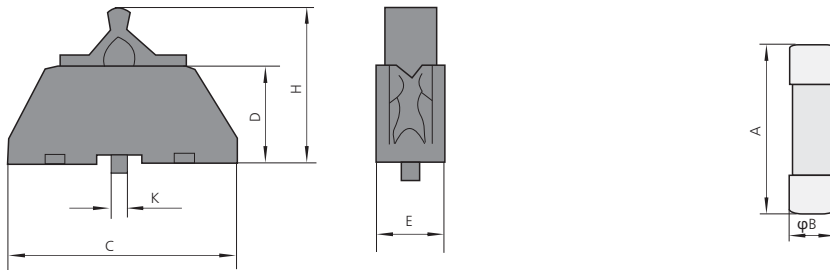

RT29-63 RT29-125 Chassis

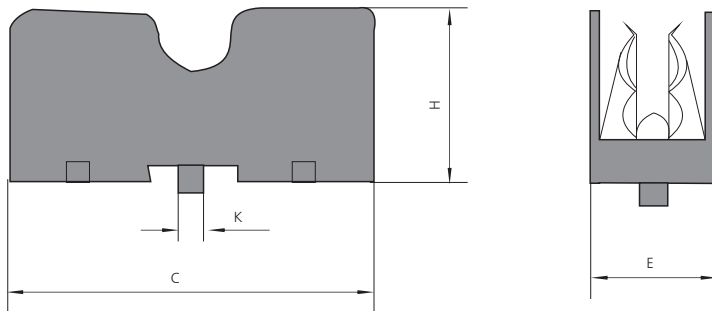

RT29-16 fuse used with RT29-16 chassis or RT29-16D chassis

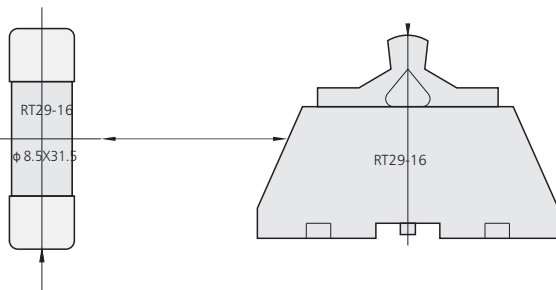

## 6. Ordering information

6.1 Specifications must be made when ordering:

6.1.1 Fuse-link shall refer to product model, rated current and quantity.

6.1.2 Fuse holder (chassis) shall define the type specification, indicate the chassis, number of poles and number of orders.

6.2 Examples for ordering: RT14-20 100 pieces, represents as the fuse-link with ordering No. RT29-32 with rated current of 16A fuse-link can only be written as RT 14-20/16A, 100 pieces.

RT29-32 (chassis) 100 pieces, represents as the fuse chassis with ordering No. RT29-32, 100 pieces.

**RT28, RT29 Fuse with Cylindrical Cap  
Protection Characteristic Curve**

